

Cylinder and Turn

Model No:
Y70/CT

Part Description:
6 Pin Cylinder and Thumbturn,
fixed cam, 70mm cylinder length.

Finish:
Satin Nickel – US15
Polish Brass – US3



Ordering No.	Cylinder Length	Finish
Y70/CT	Overall length:70mm Case Length 35 / 35	Satin Nickel – US15 Polish Brass – US3

Limiting Dimensions

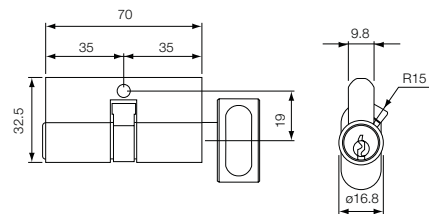

Double Cylinder

Model No:
Y70/DC

Part Description:
6 Pin Double Cylinder,
fixed cam, 70mm cylinder length.

Finish:
Satin Nickel – US15
Polish Brass – US3



Ordering No.	Cylinder Length	Finish
Y70/DC	Overall length:70mm Case Length 35 / 35	Satin Nickel – US15 Polish Brass – US3

Limiting Dimensions

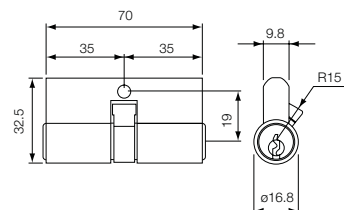

Euro Profile Cylinder

Single Cylinder

Model No:
Y45/SC

Part Description:
6 Pin Single Cylinder,
fixed cam, 45mm cylinder length.

Finish:
Satin Nickel – US15
Polish Brass – US3



Ordering No.	Cylinder Length	Finish
Y45/SC	Overall length:45mm Case Length 35 / 10	Satin Nickel – US15 Polish Brass – US3

Limiting Dimensions

