

**Technical features:**

- Steel case and striker, painted in a metallized, antique bronze colour
- Nickel-plated steel latch
- Nickel-plated steel multiple dead-bolts
- External draw-back pull
- Picking resistant protection device on the latch lever
- External key guide

**Hand:**

1 = R.H. inwards

2 = L.H. inwards

**Supplied as standard:**

- Striker
- Outside escutcheon item 1.06140.00.0
- 3 keys:
  - item 1.00120.00.1 for hand 1
  - item 1.00120.00.2 for hand 2
- Fixing screws
- Instruction sheet

Type	Description	Key item	Throws	Backset	Unit weight Kg	Pieces	ITEM				
							Type	Dim.	Hand	Fin.	Pers.

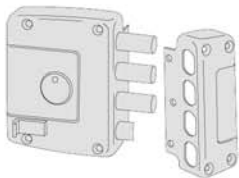

- Latch and 3 dead-bolts
- Draw-back pull



1 00125 00 1/2

4	64	2,400	1	1 57155 60 1
4	64	2,300	1	1 57155 60 2

